

WITHDRAWING MEDICATION USING A BLUNT FILL NEEDLE



Blunt fill needles

Blunt fill needles are used to draw medications out of a sealed container. Blunt filter needles have an extra filter, which filters out solid particles from the liquid. Use a blunt filter needle with any medication in a glass ampule or medications mixed from powdered form.



Never inject client with the same needle used to draw up medication.

Supplies



Medication



1–3 mL
syringe



Needle of
appropriate
size (typically
22G–25G
 $\frac{5}{8}$ "– $1\frac{1}{2}$ ")



Antiseptic
pads



Gauze
pad

Procedure

1. Open the medication vial and clean top with alcohol pad.
2. Open the syringe and blunt fill needle packages.
3. Screw the blunt fill needle onto the syringe.
4. Pull back on plunger to draw air into the syringe.
5. Uncap the blunt fill needle.
6. Puncture the rubber stopper on vial with the blunt fill needle.
7. Inject air into vial.
8. Flip vial over while maintaining the position of the needle.
9. Ensure the top of the needle is below the level of the liquid.
10. Pull back plunger to desired amount.
11. Remove blunt fill needle from vial.
12. Recap blunt fill needle with one-handed scoop method.
13. Open needle that will be used for client injection.
14. Remove blunt fill needle and screw on the injection needle.
15. Syringe and needle are ready for injection, dispose of blunt fill needle in sharps container.

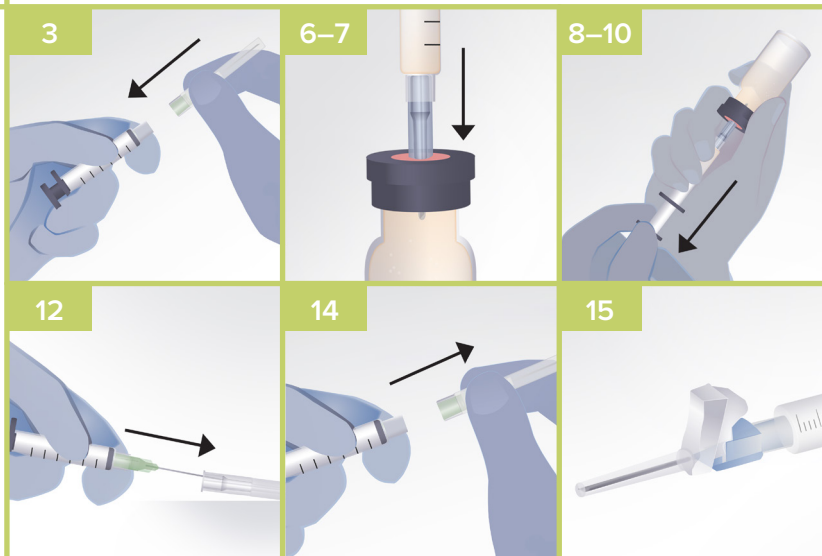

Clinical tips

- Avoid touching open ends of equipment to maintain sterility.
- Draw in at least as much air as you will have medication. It is okay to draw in more air than is needed.
- If the needle tip is above the level of liquid, you will draw air into the syringe. Keep tip of the needle within the liquid medication while drawing back plunger to avoid extra air.
- Lightly tap the syringe to remove any air bubbles in the medication.
- Eliminate extra air in syringe by pushing plunger up and directing air back into vial. Ensure your medication dosage is correct once air is removed.
- Maintain proper technique while recapping needles to avoid needle stick injuries.

NOTES

