

# HOW TO OPEN A STERILE KIT



## SUPPLIES



Sterile Kit



Hard/Flat Surface

## INSPECTING THE PACKAGE

wetness or soiled marks?

tears or openings?



expiration date?

intact sterile tape?

## Opening a Sterile Kit

1. Perform hand hygiene. Remove the plastic covering of the package.
2. Place the package on a clean, dry surface.
3. Grasp and open the furthest flap away from your body.
4. Grasp the side flap and open outward. Grasp the other side flap and open outward.
5. Grasp the final flap and open it towards your body.

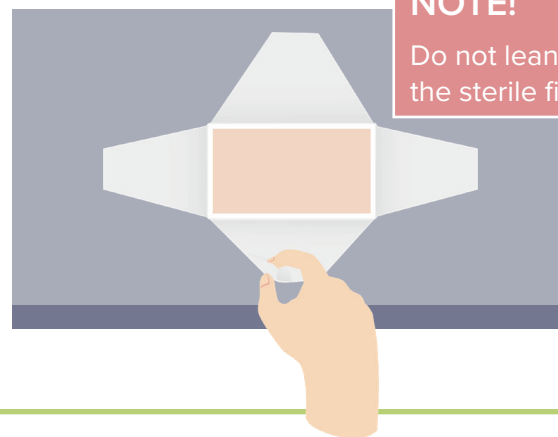
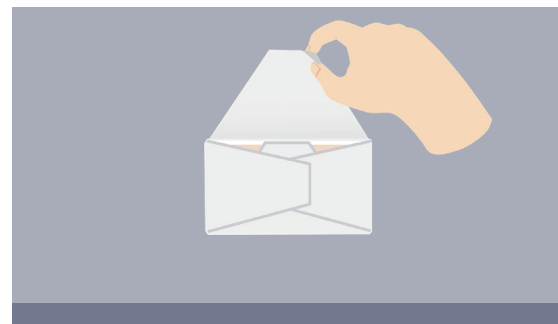

### NOTE!

Do not lean over the sterile field.

## NOTES

