

HOW TO PREP A BAG OF IV FLUID



IV Bag Equipment and Supplies



IV administration tubing



IV pole



Alcohol swabs



IV solution



Tubing labels

General IV Safety Tips

- ✓ Tubing should be labeled and dated.
- ✓ Sterility and asepsis are vital in preventing infections.
- ✓ Tubing should be traced from the patient to its source for infusion validation.
- ✓ Not all solutions are compatible.
- ✓ Infusing large amounts of air from unprimed tubing is dangerous.

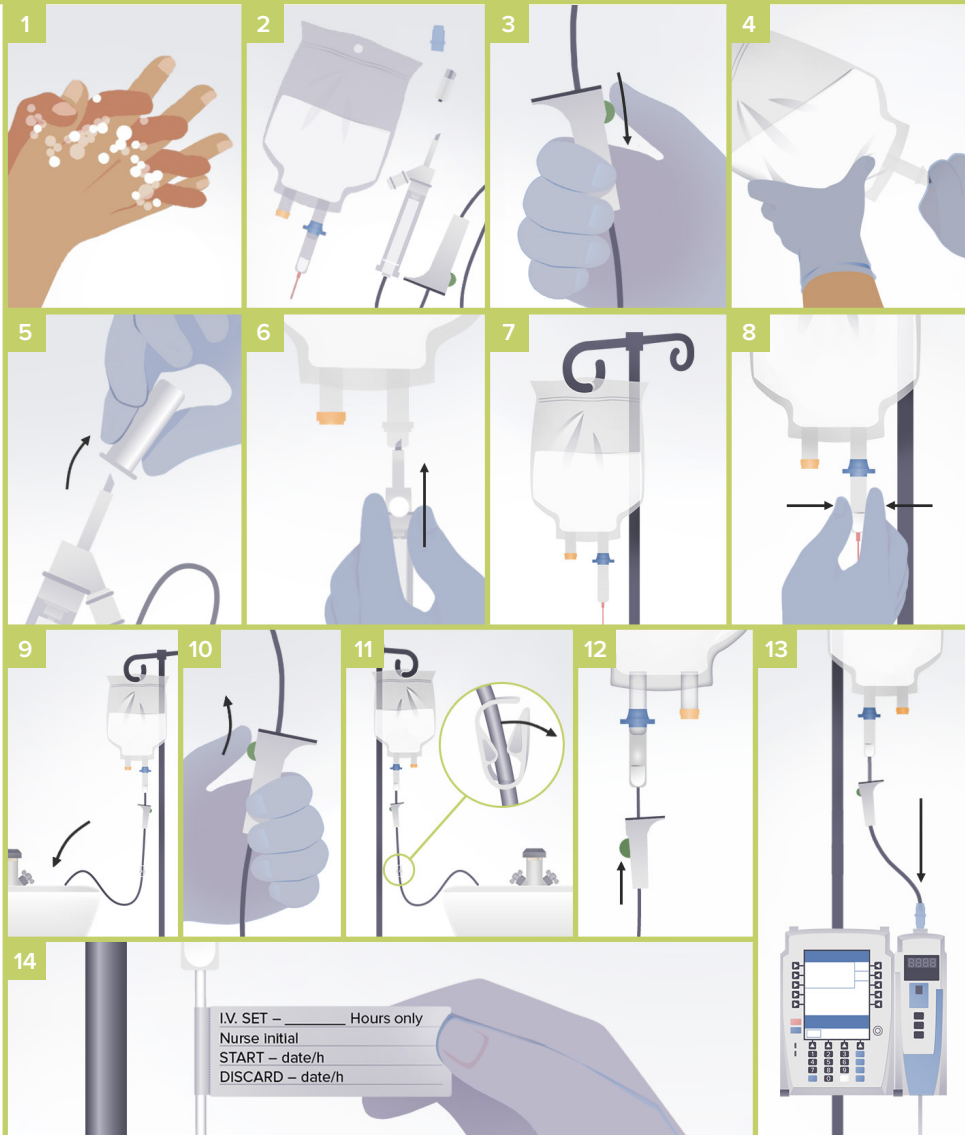

Procedure

- 1 Perform hand hygiene.
- 2 Inspect the IV site, confirm the IV solution, and verify the IV supplies.
- 3 Close the clamp of the administration tubing.
- 4 Remove the cap of the bag insertion port.
- 5 Remove the cap from the spike of the administration tubing.
- 6 Insert the spike into the bag insertion port.
- 7 Hang the spiked bag on the IV pole.
- 8 Squeeze the drip chamber until it is half full.
- 9 Aim the distal end of the IV tubing over a sink or trash bin.
- 10 Open the IV tubing roller clamp and make sure the slide clamp is open.
- 11 To prime the tubing, open the roller clamp and side clamp to allow the fluid to flow until all the air is gone.
- 12 Close the roller clamp.
- 13 Attach to the pump or flow control. Program the IV infusion pump rate.
- 14 Label the tubing. Connect the tubing to the IV site.

NOTES

IV SET - _____ Hours only
 Nurse Initial _____
 START - date/h _____
 DISCARD - date/h _____

